



Lamar Junior High (23-24)

GREG TIELKE (PRINCIPAL)



Greg 1:1

Don't ever downplay how powerful you are as a teacher.

It is all about relationships! We have the ability to change a child's trajectory!

Tielke Crew
1:1



Sayings 1:1

Right is Right and Wrong is Wrong!

If you see something or hear something make sure you say something!

I will always treat you with honor, dignity, and respect!

Relationships/Relationships/Relationships

Put kids first

Focus on self and others





MUSTANG FAMILY



Aimee Uribe



Abby Rocha



Priscilla Hernandez

LJH Customer Service



7th Grade Admin & Couns

Dr. Brent Watson (Administrator)

Jennifer Salinas (Counselor)

8th Grade Admin & Couns

Pablo Venturini (Administrator)

Jennifer Medina-Sullivan (Counselor)





Chamekia Fields



Dawn Butler



Pamela Broussard

AP of Instruction & Instructional Coaches



Andrea White



Brian Porter

Student Support Counselor &
Campus Behavior Coordinator

Vision Statement

“Lamar Junior High School is dedicated to cultivating life-long learners by offering an academically challenging environment where minds are motivated to aspire to greatness and to reach their full potential.”

Vision Statement

Motto

Motto

Set the expectation high!
Push students hard!
Watch them succeed!

Core Values

Excellence
Family
Scholarship
Respect

MUSTANGS
LAMAR JUNIOR HIGH SCHOOL



Lamar Junior High



Bell Schedule

Lamar Junior High doors will be open at **8:30 am** for students to enter.

Daily Bell Schedule		
		Instructional Time
Gyms/Cafeteria	8:30- 9:00	
1 st	9:05- 9:55	50 min
Mustang Time	9:59- 10:24	25 min
2 nd (Attendance by 10:45)	10:28-11:18 (LCHS 3 rd - 10:25-11:20)	50 min
3 rd	11:22 - 12:12 (LCHS 4 th 11:25-12:20)	50 min
4 th	12:16-1:46	90 min
5 th	1:50-2:40 (LCHS 6 th 1:55-2:50)	50 min
6 th	2:44-3:34 (LCHS 7 th 2:55-3:50)	50 min
7 th	3:38- 4:30	52 min

****There will be a 1-minute WARNING bell before the tardy bell****

4 th Period Schedule		
12:16-12:46	12:46-1:16	1:16-1:46
A Lunch	Class	
Class	B Lunch	Class
Class		C Lunch

Start & End Times

Start: 9:05 AM

We open the doors to the
school @ 8:30 AM

End: 4:30 PM

Walkers

Car Riders

Bus Riders



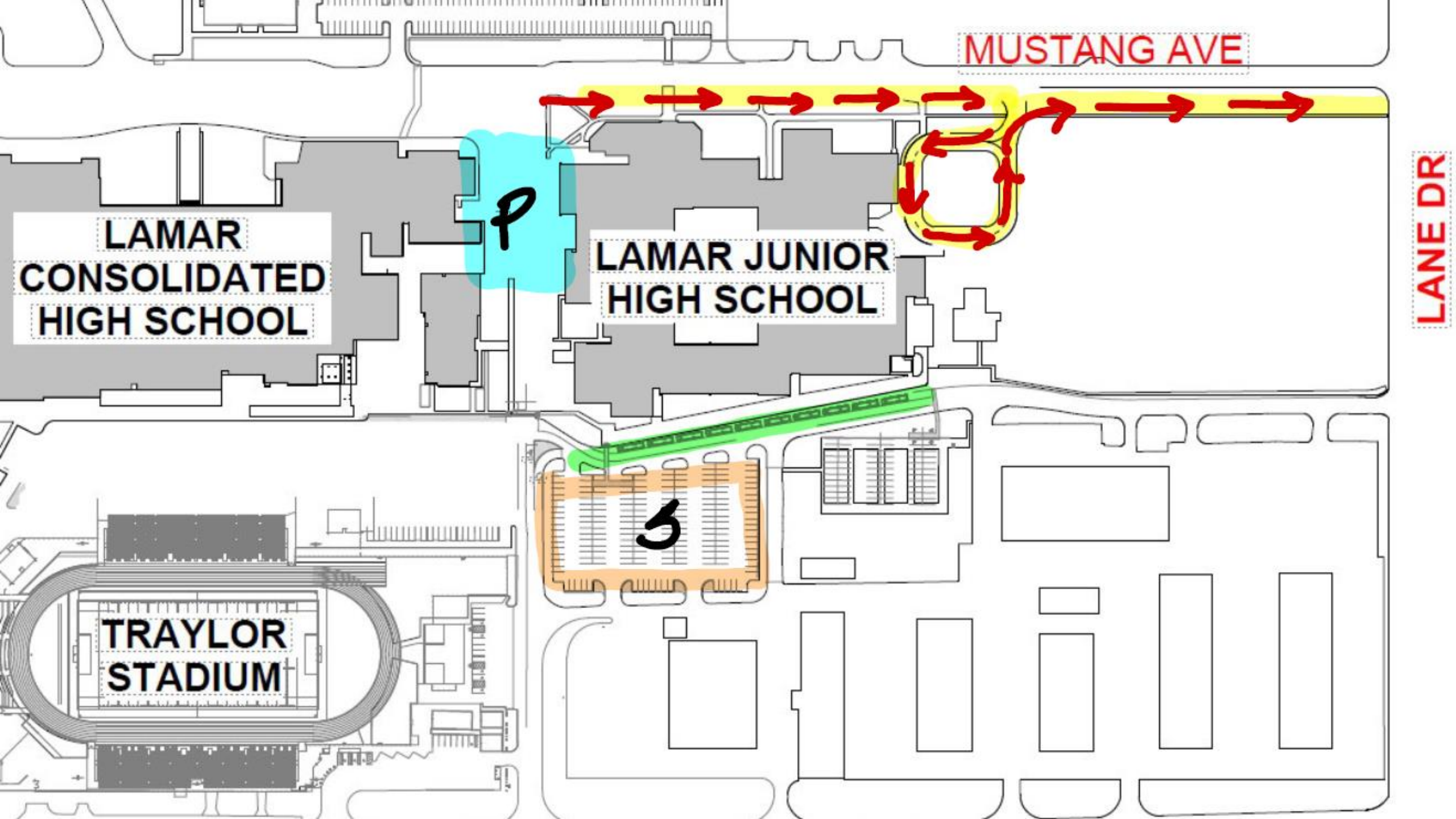

Safety 1st



STANDARD™
RESPONSE PROTOCOL
FOR STUDENTS AND TEACHERS

4 ACTIONS

Secure

Lockdown

Evacuate

Shelter



Classroom Signage

Drills and Emergencies

IN AN EMERGENCY TAKE ACTION



HOLD! In your room or area. Clear the halls.

STUDENTS

Clear the hallways and remain in room or area until the "All Clear" is announced
Do business as usual

ADULTS

Close and lock door
Account for students and adults
Do business as usual



SECURE! Get inside. Lock outside doors.

STUDENTS

Return to inside of building
Do business as usual

ADULTS

Bring everyone indoors
Lock outside doors
Increase situational awareness
Account for students and adults
Do business as usual



LOCKDOWN! Locks, lights, out of sight.

STUDENTS

Move away from sight
Maintain silence
Do not open the door

ADULTS

Recover students from hallway if possible
Lock the classroom door
Turn out the lights
Move away from sight
Maintain silence
Do not open the door
Prepare to evade or defend



EVACUATE! (A location may be specified)

STUDENTS

Leave stuff behind if required to
If possible, bring your phone
Follow instructions

ADULTS

Lead students to Evacuation location
Account for students and adults
Notify if missing, extra or injured students or adults



SHELTER! Hazard and safety strategy.

STUDENTS

Use appropriate safety strategy for the hazard

ADULTS

Lead safety strategy
Account for students and adults
Notify if missing, extra or injured students or adults

Hazard	Safety Strategy
Tornado	Evacuate to shelter area
Hazmat	Seal the room
Earthquake	Drop, cover and hold
Tsunami	Get to high ground

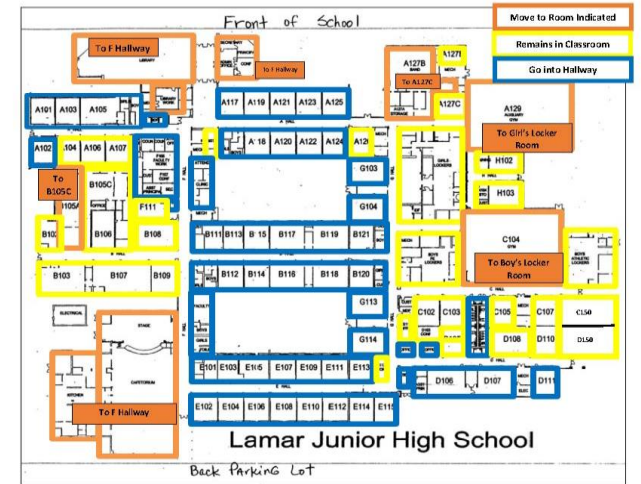
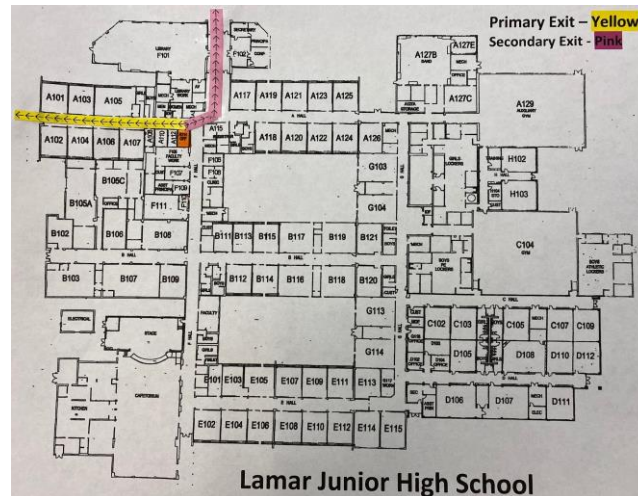



Smart Tag & Safety Cards

All students will receive:

- SMART Tag/ID
- Student Safety Card
- Lanyard/Sleeve Holder

All students & staff:

- Required to wear their IDs @ all times
- Failure to wear will be a dress code violation

In the event, a **student loses or misplaces** their SMART Tag/ID a new one will need to be **purchased!**



Projections “Don’t Equal Reality”



“The Power of Us”

Tier 1 Instruction (Essential Standards)

Purposeful Planning “Us Time”

Customer Service

MTSS Process & MUSTang Time

Essential Skills “Mustang Way”

Community Outreach

Focus on self and others

Collaborative Culture



Focus on Learning

Focus on Results



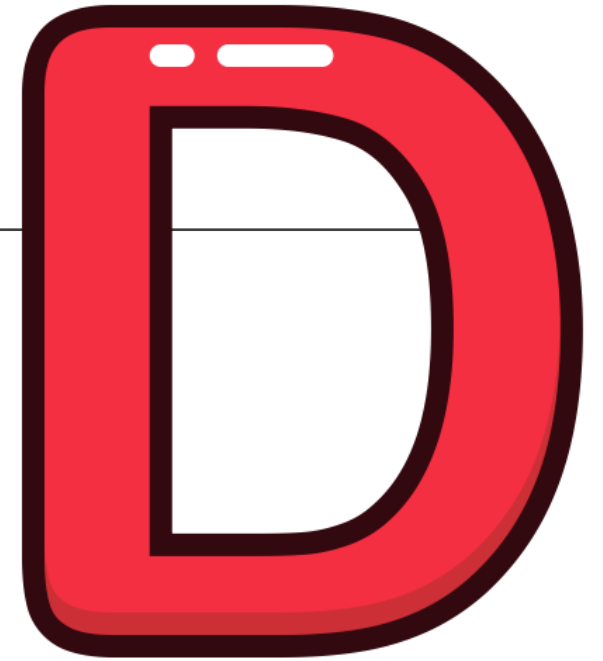
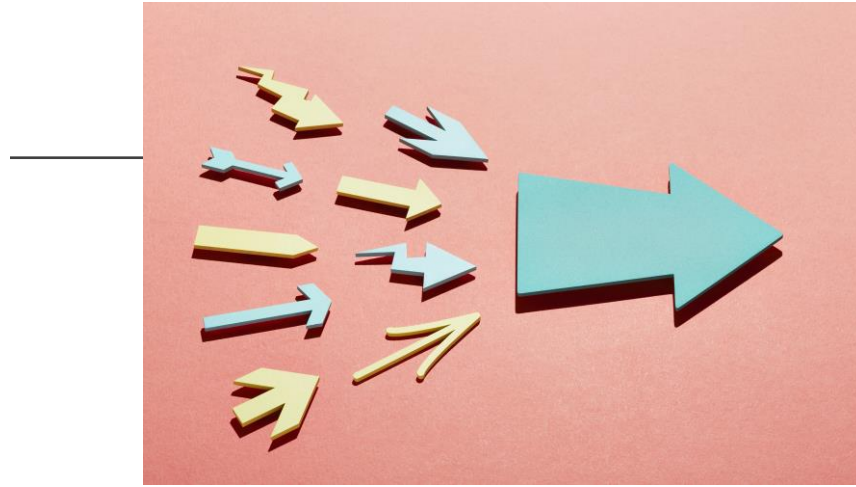

LJH's 21- 22 Projections



Hard Work & Grit

D

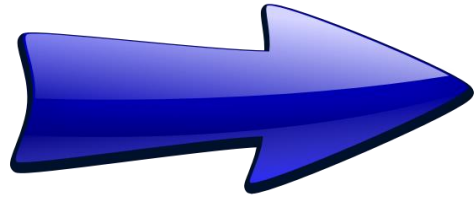

B

**BLUE
STAMPEDE**

21/22 Results “Impact the Track”

22-23 School Year (TBD)

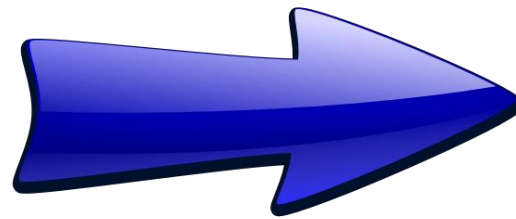
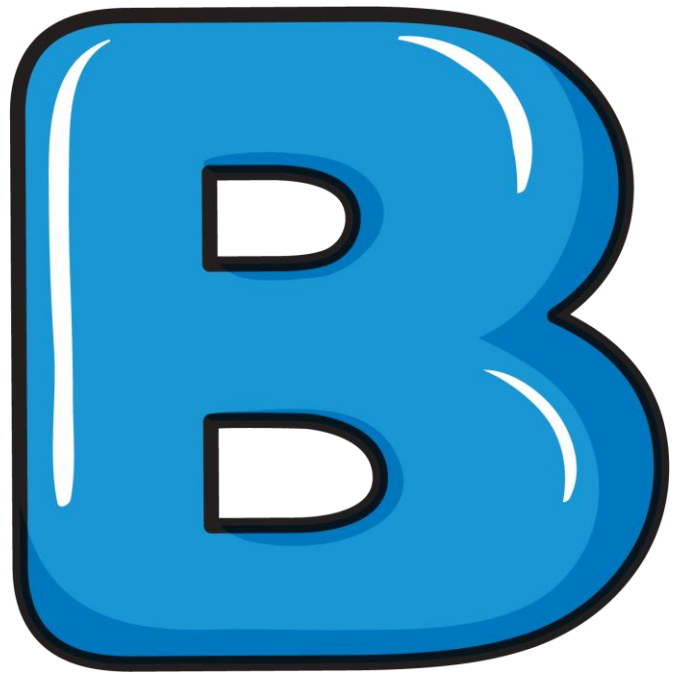



23/24
Campus
Goal



Hyper-Sensitive Focus

Continue to change the narrative!



Components of the redesign

Cross Curricular Passages

Evidence Based Writing in RLA Assessments

Online Administration

New Item Types

Interventions

Before School Tutoring

8:30 – 9:00 AM

MUSTang Time (During the Day)

Late Night Learning Lab



TM



AVID
Elective

7th Grade

AVID Elective

AVID Elective is a transitional course that helps seventh graders to ease into junior high with confidence and success.

AVID Elective was developed to scaffold our students through personalized lessons towards independence with the lifelong skills and habits they need.

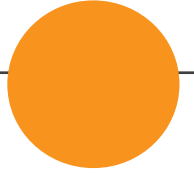



"Bring Out the Best With PBIS"

PBIS Matrix

LAMAR MUSTANGS ARE...

READY

"DO WHAT IS RIGHT"

RESPECTFUL

"TREAT OTHERS WELL"

RESPONSIBLE

"OWN YOUR LEARNING AND ACTIONS"

LJH CLASSROOM
Lamar Junior High School

<p>Ready "Do what is right"</p>	<p>Be Prepared and Ready to Learn</p>
<p>Respectful "Treat others well"</p>	
<p>Responsible "Own your learning and actions"</p>	

READY
"DO WHAT IS RIGHT"
Have proper restroom pass

RESPECTFUL
"TREAT OTHERS WELL"
Keep restroom safe and clean.
Keep hands and feet and other objects to yourself.

RESTROOM

RESPONSIBLE
"OWN YOUR LEARNING AND ACTIONS"
Take care of your business and leave.
Report any Issues or concerns to an adult.

READY
"WHAT IS RIGHT"
MOVE WITH PURPOSE
WALK AND TALK

RESPECTFUL
"TREAT OTHERS WELL"
WALK ON THE RIGHT SIDE OF THE HALLWAY.
KEEP HANDS AND FEET AND OTHER OBJECTS TO YOURSELF.
USE APPROPRIATE LANGUAGE

RESPONSIBLE
"OWN YOUR LEARNING AND ACTIONS"
RESPECT EACH OTHERS SPACE.
USE TIME WISELY
KEEP HALLWAYS CLEAN

HALLWAYS



READY
"WHAT IS RIGHT"
REPORT AND STAY IN YOUR ASSIGNED AREA

RESPECTFUL
"TREAT OTHERS WELL"
BE POLITE AND COURTEOUS
REPRESENT YOUR BEST SELF

RESPONSIBLE
"OWN YOUR LEARNING AND ACTIONS"
ARRIVE AND DEPART ON TIME
BE WHERE YOU'RE SUPPOSED TO BE

BUS/CAR

READY
"DO WHAT IS RIGHT"
Report and Stay at Assigned Area.

RESPECTFUL
"TREAT OTHERS WELL"
Keep Body parts inside the vehicles at all times.
Follow the instructions given by an adult.

RESPONSIBLE
"OWN YOUR LEARNING AND ACTIONS"
Follow the rules and be safe.
Report any issues to an adult.

READY
"WHAT IS RIGHT"
Come in quietly and sit at your assigned table.

RESPECTFUL
"TREAT OTHERS WELL"
Treat peers, and adults with Respect!

RESPONSIBLE
"OWN YOUR LEARNING AND ACTIONS"
Clean up your Area!
Food and Drinks stay in the Cafeteria.
Stay in your seat and at your table.

LAMAR JUNIOR HIGH SCHOOL

CAFETERIA



BOY Forms (23 / 24 School Year)

For the 2023-24 school year, all LCISD campuses will be using Skyward's Beginning of Year form functionality to reduce the number of paper forms students are required to have signed and returned at the start of the school year. This functionality will be a seamless integration with the Skyward Family Access Center and will save you, the parent, time in filling out these forms as well as the campus staff in entering that data in our student information system.

Instructions for Completing Online Forms:

Completing the Beginning of Year online forms through Skyward Family Access is very easy and will take just a few minutes. Below are your steps for completing these forms:

1. Click on the Family Access login button to the right.
2. Login with your LCISD Family Access credentials.
3. Click on the Beginning of Year Forms link in the Family Access main menu.
4. Complete each step, making changes as necessary, and clicking the "Complete Step X" button at the bottom of each form.
5. Once all forms are complete, click the "Submit Beginning of Year Forms" button on the last page.

To support you in completing these forms online, we have created a short video walking you through each of these steps.

Family Access Link

Login

Family Access Help

Forgot Username/Password

CEP (Community Eligibility Program)

LAMAR CONSOLIDATED INDEPENDENT SCHOOL DISTRICT

2023-2024 Community Eligibility Program (CEP) Information Form **Programa de Elegibilidad Comunitaria (CEP) Formulario de Información 2023-2024**

CONFIDENTIAL // CONFIDENCIAL

Lamar CISD is required to collect and report the economic status of each student to the Texas Education Agency for purposes of the annual state accountability ratings and for federal reporting. Please note that this form is not sent to the Texas Education Agency and that the income levels indicated for your family are not reported to the Texas Education Agency. Only the Economically Disadvantaged status of each student as determined by the information provided is reported to the Texas Education Agency. The data collected will be used in reporting the status of students and in the allocation of funding to campuses.

Approval of Student Code of Conduct

School Board Approval of Student code of Conduct

Tuesday, October 1, 2023

What changes have occurred?

2023-2024 Handbook

The Student Code of Conduct can be found within the 2023-2024 Student Handbook.

Secondary – pg. 149

Elementary – pg. 91

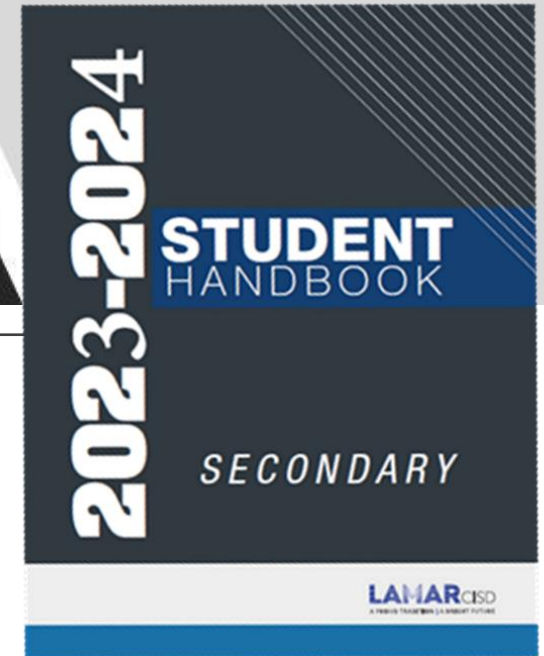

The updated handbook can be found on the LCISD webpage at the bottom right-hand side under the Student & Parent section





Spanish version will be uploaded once they are completed.

Handbooks and Policies







General Information

 [New Student Enrollment Checklist \(English & Spanish\)](#)
PDF, 237.05 KB

Elementary Handbooks & Policies

-  [2023-2024 Elementary Handbook - FINAL REVISED](#)
PDF, 1.86 MB
-  [2023-2024 Elementary Handbook - WITH CHANGES](#)
PDF, 1.86 MB
-  [2023-2024 Elementary Orientation and Open House Schedule](#)
PDF, 222.00 KB
-  [2023-2024 Elementary School Supply List](#)
PDF, 179.49 KB
-  [2023-2024 Elementary Dress Code](#)
PDF, 264.27 KB

Secondary Handbook & Policies

-  [2023-2024 Secondary Handbook - FINAL REVISED](#)
PDF, 1.51 MB
-  [2023-2024 Secondary Handbook - WITH CHANGES](#)
PDF, 1.51 MB
-  [2023-2024 Secondary Orientation and Open House Schedule](#)
PDF, 122.01 KB
-  [2023-2024 Middle and JH Supply List](#)
PDF, 2.01 MB
-  [2023-2024 Course Catalog](#)
PDF, 4.71 MB
-  [2022-2023 Secondary Student Handbook \(Spanish\)](#)
PDF, 2.55 MB

**Minor Offenses
2022-2023**

- **(BUS)** Failure to follow bus rules (follow bus discipline guide)
- **(CHE)** Cheating/Copying
- **(COM)** Computer system misuse
- **(DIS)** Disturbing/taunting, disruptive noises
- **(DRE)** Dress code violation
- **(ELP)** Elopement-leaving classroom/campus
- **(FAI)** Classroom rules violation
- **(FAI)** Food or drink in restricted area
- **(FAI)** Cutting in line
- **(FAI)** Lack of class preparation
- **(FAI)** Sleeping in class
- **(FAI)** Failure to participate in class
- **(FAI)** Inappropriate toys/items brought to school
- **(HSP)** Horse playing
- **(IAT)** Public display of affection/exhibiting inappropriate familiarity
- **(MLD)** Misuse of cellphone/electronic device/social media
- **(NON)** Noncompliant behavior in classroom
- **(NON)** Dishonesty
- **(PKV)** Parking lot violation
- **(TAR)** Tardy
- **(TSH)** Threat to self-harm

**Minor Offenses
2023-2024**

- **(BUS)** Failure to follow bus rules (follow bus discipline guide)
- **(CHE)** Cheating/Copying
- **(COM)** Computer system misuse
- **(DIS)** Disturbing/taunting, disruptive noises
- **(DRE)** Dress code violation
- **(ELP)** Elopement-leaving classroom/campus
- **(FAI)** Classroom rules violation
- **(FAI)** Food or drink in restricted area
- **(FAI)** Cutting in line
- **(FAI)** Lack of class preparation
- **(FAI)** Sleeping in class
- **(FAI)** Failure to participate in class
- **(FAI)** Inappropriate toys/items brought to school
- **(HSP)** Horse playing
- **(IAT)** Public display of affection/exhibiting inappropriate familiarity
- **(MLD)** Misuse of cellphone/electronic device/social media
- **(NON)** Noncompliant behavior in classroom
- **(NON)** Dishonesty
- **(PKV)** Parking lot violation
- **(TAR)** Tardy
- **(TSH)** Threat to self-harm

CHANGES TO DISCIPLINE CODE CHART

Level I Offenses

No Changes!

CHANGES TO DISCIPLINE CODE CHART *Level II Offenses*

***Removed
VAP – E-cigarette***

***Additions
FAI - Student found in an
unapproved location***

Major Offenses 2022-2023

- (CHE) Plagiarism
- (DIS) Disturbing and taunting
- (EDW) Fireworks
- (FAI) Throwing objects
- (FAI) Sell/ distribute non-school related items
- (FAI) Possession of a laser pointer
- (FAI) Possessing/using matches or lighter
- (GAM) Gambling
- (IAT) Inappropriate touching/ physical contact
- (LAG) Profane/abusive language
- (NON) Noncompliant behavior/Insubordination
- (RAC) Racial slurs
- (SKI) Skips class/ leaves class w/o permission/ leaves school grounds
- (SP1) Persistent level I misbehavior (begin MTSS)
- (SXT) Sexting
- (TOB) Possession of tobacco products/ paraphernalia
- (TRE) Trespassing
- **(VAP) Vape/ E-cigarette**
- (VBC) Verbal confrontation

Major Offenses 2023-2024

- (CHE) Plagiarism
- (DIS) Disturbing and taunting
- (EDW) Fireworks
- (FAI) Throwing objects
- (FAI) Sell/ distribute non-school related items
- (FAI) Possession of a laser pointer
- (FAI) Possessing/using matches or lighter
- **(FAI) Student found in unapproved location**
- (GAM) Gambling
- (IAT) Inappropriate touching/ physical contact
- (LAG) Profane/abusive language
- (NON) Noncompliant behavior/Insubordination
- (RAC) Racial slurs
- (SKI) Skips class/ leaves class w/o permission/ leaves school grounds
- (SP1) Persistent level I misbehavior (begin MTSS)
- (SXT) Sexting
- (TOB) Possession of tobacco products/ paraphernalia
- (TRE) Trespassing
- (VBC) Verbal confrontation

**Major Offenses/ Discretionary
Removal Offenses (DAEP)
2022-2023**

- (BUL) * Bullying/cyberbullying
- (BUD/BUG/BUR) * Bullying/cyberbullying based on disability/ gender/ race
- (CCS) * Class C misdemeanor assault of student
- (CUL) *Cult drawings/Notes
- (DES/VAN) * Destruction of school property/Vandalism
- (DRP) *Drug paraphernalia
- (EDC) Deadly conduct**+
- (EDW)* Explosive device (not used as threat/non-felony)
- (FIG) * Fighting
- (FOR) *Falsification of records/ Forgery
- (FLR) * Student makes false report
- (GAN/GAV) * Gang/secret society activity / Gang violence
- (HAZ) * Hazing
- (KNI) * Possession of non-illegal knife
- (LAW) * Look-alike weapon/ weapon replica
- (LAD) * Possessing or selling look-alike drugs
- (MCD) * Major campus disruption/ Common area disruption
- (MLD) Use of electronic device to capture images/video of code of conduct violations
- (OCO)** Felony off campus non-school event (not title 5)
- (PHC) Physical conflict/confrontation/ aggression towards another
- (POR) *Possession of pornography
- (SP2) Persistent level II misbehavior (MTSS required)
- (SP3) * + Serious and persistent level III misbehavior (MTSS required)
- (STL) * Stealing/Theft
- (SXH) * Sexual harassment/dating violence
- (SXM) * Sexual misconduct
- (SXN) * Registered sex offender not on probation
- (TRS) threats to student
- (VAS/VAT) * Destruction of student or teacher property/Vandalism

**Major Offenses/
Discretionary Removal
Offenses (DAEP/ALC)
2023-2024**

- (BUL) * Bullying/cyberbullying
- (BUD/BUG/BUR) * Bullying/cyberbullying based on disability/ gender/ race
- (CUL) *Cult drawings/Notes
- (EDW)* Explosive device (not used as threat/non-felony)
- (FIG) * Fighting
- (FOR) *Falsification of records/ Forgery
- (FLR) * Student makes false report
- (GAN/GAV) * Gang/secret society activity / Gang violence
- (HAZ) * Hazing
- (LAW) * Look-alike weapon/ weapon replica
- (MCD) * Major campus disruption/ Common area disruption
- (NON) Noncompliant behavior/Insubordination
- (OCO)** Felony off campus non-school event (not title 5)
- (PHC) Physical conflict/confrontation/ aggression towards another
- (POR) *Possession of pornography
- (SP2) Persistent level II misbehavior (MTSS required)
- (SXH) * Sexual harassment/dating violence
- (SXN) * Registered sex offender not on probation
- (TRS) Threats to student

**CHANGES TO
DISCIPLINE CODE
CHART
Level III Offenses**

Removed
CCS – Class C Misdemeanors
DES/Van – Destruction of property
DRP – Drug Paraphernalia
EDC – Deadly Conduct
KNI – Knife less than 5.5 in
LAD – Look Alike Drugs
SPE – Serious and Persistent
SXM – Sexual Misconduct
TRS – Threat to Student
VAS/VAT – Vandalism
student/teacher property

Additions
NON – Non-Compliant Behavior



July 31, 2023

Vape

Dear Lamar CISD Community,

As we prepare for the start of the school year, we want to inform you about a significant legislative change that will directly impact our school community.

On September 1, 2023, [House Bill 114](#) (HB 114), will go into effect, which is a law that aims to address the serious issue of vaping/e-cigarette use among students. Under this law, any student found in possession of any kind of vaping/e-cigarette device on campus premises will face immediate and automatic placement in a **Disciplinary Alternative Education Program (DAEP).**

**DISCIPLINE CODE
CHART
Level IV Offenses**

Removed

ASL – Assault of LCISD Staff Member
ASV – Assault of Volunteer

Additions

CCS – Class C Misdemeanor Assault
DES/VAN – Destruction of School Property
DRP – Drug Paraphernalia
KNI – Possession of Knife less than 5.5 in
LAD – Possessing/selling look-alike drug
MLD – Use of electronic devices to capture violations
SP3 – Serious and persistent Level III
STL – Stealing/theft
SXM – Sexual Misconduct
SXS – Registered Sex Offender
VAP – Vape/E-cigarette
VAS/VAT – Destruction of Student/teacher property

**Mandatory (DAEP) or
discretionary expulsions
2022-2023**

- (ALC) ^ ** + Alcohol (non-felony) on campus or school activity
- **(ASL) ^ + ** Assault of LCISD staff member**
- (AST) ^ ** Assault of a student on campus
- **(ASV) ^ + ** Assault of volunteer**
- (DRU) ^ ** + Drugs, controlled substance, dangerous drugs on campus (non-felony) or school activity
- (DRU) ^ ** Under the influence on campus
- (FAL) ^ + ** False alarm, false report
- (FEL) ^ ** Felony on campus or school activity
- (GLU) ^ ** + Abuse of volatile chemicals on campus or school activity
- (HAR) ** verbal/physical threat to staff, inappropriate language to staff ...
- (INX) ^ ** Indecent exposure on campus or school activity
- (OCF) ^ ** + Title V Felony (off campus)
- (PLD) ^ ** Public lewdness on campus or school activity
- (RET) ^ ** + Retaliation against school employee on campus or Off campus
- (SXS) ^ ** Registered sex offender – court supervision
- (TTR) ^ ** + Terroristic Threat

**Mandatory (DAEP/ALC) or
discretionary expulsions
2023-2024**

- (ALC) ^ ** + Alcohol (non-felony) on campus or school activity
- (AST) ^ ** Assault of a student on campus (1st offense)
- **(CCS) * Class C misdemeanor assault of student**
- **(DES/VAN) * Destruction of school property/Vandalism**
- **(DRP) * Drug paraphernalia**
- (DRU) ^ ** + Drugs, controlled substance, dangerous drugs on campus (non-felony) or school activity
- (DRU) ^ ** Under the influence on campus
- (FAL) ^ + ** False alarm, false report
- (FEL) ^ ** Felony on campus or school activity
- (GLU) ^ ** + Abuse of volatile chemicals on campus or school activity
- (HAR) ** verbal/physical threat to staff, inappropriate language to staff
- (INX) ^ ** Indecent exposure on campus or school activity
- **(KNI) * Possession of non-illegal knife (blades between 2 inches & 5.5 inches)**
- **(LAD) * Possessing or selling look-alike drugs**
- **(MLD) Use of electronic device to capture images/video of code of conduct violations**
- (OCF) ^ ** + Title V Felony (off campus)
- (PLD) ^ ** Public lewdness on campus or school activity
- (RET) ^ ** + Retaliation against school employee on campus or off campus
- **(SP3) * + Serious and persistent level III misbehavior (MTSS required)**
- **(STL) * Stealing/Theft**
- **(SXM) * Sexual misconduct**
- **(SXS) ^ ** Registered sex offender – court supervision**
- (TTR) ^ ** + Terroristic Threat
- **(VAP) Vape/ E-cigarette**
- **(VAS/VAT) * Destruction of student or teacher property/Vandalism**

Expellable Offenses

Expulsion Placements must be supported with Police Report
2022-2023

Discretionary

- **(BCS)** + Breach of computer security
- **(CRM)** ^ + Criminal mischief (felony)

Mandatory

- **(AAL)** ^++Aggravated Assault of Employee or Volunteer
- **(AAO)** ^++Aggravated Assault of student/parent on campus
- **(ARS)** ^++Arson on campus or school activity
- **(ASA/ASO)** ^++Sexual assault or aggravated sexual assault on campus
- **(CNH)** ^ ++ Criminal negligent homicide on campus
- **(FAV)** ^ ++ Felony Alcohol
- **(FCS)** ^ ++Felony Drug Controlled substance
- **(IND)** ^++ Indecency with a child on campus or school activity
- **(KID)** ^++Aggravated kidnapping on campus
- **(MSL)** ^ ++ Manslaughter on campus
- **(MUR)** ^++Murder, capital murder, or attempt to commit murder on campus
- **(ROB)** ^++ Aggravated robbery on campus
- **(SXA)** ^++Continuous sexual abuse of a child on campus
- **(WPF)** ^++Firearm on campus
- **(WPK)** ^++Illegal Knife on campus
- **(WPO)** ^++Prohibited weapons on Campus (other)

Expellable Offenses

Expulsion Placements must be supported with Police Report
2023-2024

Discretionary

- **(BCS)** + Breach of computer security
- **(CRM)** ^ + Criminal mischief (felony)

Mandatory

- **(AAL)** ^++Aggravated Assault of Employee or Volunteer
- **(AAO)** ^++Aggravated Assault of student/parent on campus
- **(ARS)** ^++Arson on campus or school activity
- **(ASA/ASO)** ^++Sexual assault or aggravated sexual assault on campus
- **(ASL)** ^ + ****Assault of LCISD staff member**
- **(AST)** ^ **** Assault of a student on campus (2nd offense)**
- **(ASV)** ^ + ****Assault of volunteer**
- **(CNH)** ^ ++ Criminal negligent homicide on campus
- **(EDC)** **Deadly conduct^{^++}**
- **(FAV)** ^ ++ Felony Alcohol
- **(FCS)** ^ ++Felony Drug Controlled substance
- **(IND)** ^++ Indecency with a child on campus or school activity
- **(KID)** ^++Aggravated kidnapping on campus
- **(MSL)** ^ ++ Manslaughter on campus
- **(MUR)** ^++Murder, capital murder, or attempt to commit murder on campus
- **(ROB)** ^++ Aggravated robbery on campus
- **(SXA)** ^++Continuous sexual abuse of a child on campus
- **(WPF)** ^++Firearm on campus
- **(WPK)** ^++Illegal Knife on campus **(blade larger than 5.5 inches)**
- **(WPO)** ^++Prohibited weapons on Campus (other)

DISCIPLINE CODE CHART

Level V Offenses

Additions

ASL – Assault of LCISD Staff Member

AST – Assault of Student (2nd – Offense)

ASV – Assault of Volunteer

EDC – Deadly Conduct

Adjusted

WKF – Illegal knife w/blade longer than 5.5 in

Color Coded Offenses

Offenses are color coded based on the level of violation based on the Texas Penal Code and the possible charge.

No Color – Class C Misdemeanor

Green – Class A Misdemeanor

Purple – Class B Misdemeanor

Yellow – Class A or B Misdemeanor

Blue – Felony Offense

Major Offenses/

Mandatory (DAEP/ALC) or discretionary expulsions

- (ALC) ^ **+Alcohol (non-felony) on campus or school activity
- (AST) ^ ** Assault of a student on campus (1st offense)
- (CCS) * Class C misdemeanor assault of student
- (DES/VAN) * Destruction of school property/Vandalism
- (DRP) *Drug paraphernalia
- (DRU) ^ ** + Drugs, controlled substance, dangerous drugs on campus (non-felony) or school activity
- (DRU) ^ ** Under the influence on campus
- (FAL) ^ + ** False alarm, false report
- (FEL) ^ ** Felony on campus or school activity
- (GLU) ^ ** + Abuse of volatile chemicals on campus or school activity
- (HAR)**verbal/physical threat to staff, inappropriate language to staff
- (INX) ^ ** Indecent exposure on campus or school activity
- (KNI) * Possession of non-illegal knife (blades between 2 inches & 5.5 inches)
- (LAD) * Possessing or selling look-alike drugs
- (MLD) Use of electronic device to capture images/video of code of conduct violations
- (OCF) ^ ** + Title V Felony (off campus)
- (PLD) ^ ** Public lewdness on campus or school activity
- (RET) ^ ** + Retaliation against school employee on campus or off campus
- (SP3) * + Serious and persistent level III misbehavior (MTSS required)
- (STL) * Stealing/Theft
- (SXM) * Sexual misconduct
- (SXS) ^ ** Registered sex offender – court supervision
- (TTR) ^ ** + Terroristic Threat
- (VAP) Vape/ E-cigarette
- (VAS/VAT) * Destruction of student or teacher property/Vandalism

Expellable Offenses Expulsion Placements must be supported with Police Report

- Discretionary
- (BCS) + Breach of computer security
 - (CRM) ^ + Criminal mischief (felony)
- Mandatory
- (AAL) ^++Aggravated Assault of Employee or Volunteer
 - (AAO) ^++Aggravated Assault of student/parent on campus
 - (ARS) ^++Arson on campus or school activity
 - (ASA/ASO) ^++Sexual assault or aggravated sexual assault on campus
 - (ASL) ^ + **Assault of LCISD staff member
 - (AST) ^ ** Assault of a student on campus (2nd offense)
 - (ASV) ^ + **Assault of volunteer
 - (CNH) ^ ++ Criminal negligent homicide on campus
 - (EDC) Deadly conduct^*+
 - (FAV) ^ ++ Felony Alcohol
 - (FCS) ^ ++Felony Drug Controlled substance
 - (IND) ^++ Indecency with a child on campus or school activity
 - (KID) ^++Aggravated kidnapping on campus
 - (MSL) ^ ++ Manslaughter on campus
 - (MUR) ^++Murder, capital murder, or attempt to commit murder on campus
 - (ROB) ^++ Aggravated robbery on campus
 - (SXA) ^++Continuous sexual abuse of a child on campus
 - (WPF) ^++Firearm on campus
 - (WPK) ^++Illegal Knife on campus (blade larger than 5.5 inches)
 - (WPO) ^++Prohibited weapons on Campus (other)

Green-Class A Misdemeanor; Purple-Class B Misdemeanor; Yellow-Class A or B Misdemeanor; Blue-Felony; Student will receive a citation from LCISD Police and in accordance with Texas law the offense is reported to the law enforcement municipality in which the school is located.

*Denotes discretionary DAEP placement **Denotes mandatory DAEP placement +Denotes discretionary expulsion ++Denotes mandatory expulsion ^Denotes police documentation required for expulsion

Minor Offenses	Major Offenses	Major Offenses / Discretionary Removal Offenses (DAEP)	Mandatory (DAEP) or discretionary expulsions	Expellable Offenses Expulsion Placements must be supported with Police Report
Required minimum: Reprimand/Verbal correction Student Conference Confiscation (if applicable) Administrative Fee (cell phone - \$15 for 2 nd offense and beyond)	Required minimum: Discipline referral documentation Confiscation (if applicable) Parent contact Student Conference	Required minimum: Discipline referral documentation ISS OSS (3-day max.) Parent contact /conference Student Conference	Required minimum: Discipline referral documentation ALC Administrator notifies LCISD Police Parent contact and conference Student Conference Restitution (for damage of school property if applicable) Loss of privileges Removal from extra-curricular activities	Required minimum: Discipline referral documentation Expulsion Police Notification Parent contact and conference Student Conference
Optional: Cooling off time Discipline referral Parent contact Dress correction (dress code) Short term class removal Loss of privileges After School Detention Bus suspension (BUS) Parking privilege suspension Restorative practices (RP)	Optional: ISS OSS (3-day max.) Loss of privileges Removal from extra-curricular activities Saturday school Class reassignment After school detention Restorative practices (RP) ALC discretionary	Optional: ALC discretionary noted by * Class reassignment Police Notification Loss of privileges Removal from extra-curricular activities Restorative practices (RP)	Optional: OSS (3 days max) Assign Campus Service Opportunities Repairing, repainting, or cleaning for damages	Based on Chapter 37.007 of the Texas Education Code

Discipline levels are not limited to only those behaviors represented in the chart above.

All Expulsion Placements must be supported with Police Report

Mandatory Expulsion Placements will be placed at ALC or JJAEP

Discretionary Expulsion Placements will be placed at ALC or JJAEP

Expulsion days can range from 30 school days to 173 school days at JJAEP

On campus also includes school sponsored events

Director of Student Discipline is the Hearing Officer for all Expulsion Placements



Cell Phone Policy Changes

Inappropriate Use of Cell Phone

Inappropriate use of Cell Phone Practice:

- 1st Offense – Parent Contact, Phone confiscated and returned at end of day.
- 2nd Offense – Parent Contact, Phone confiscated, and parent must retrieve phone with a \$15 fee.
- 3rd Offense – Parent Contact, Phone confiscated, parent must retrieve phone with a \$15 fee, and student is assigned ISS.
- 4th Offense - Parent Contact, Phone confiscated, parent must retrieve phone with a \$15 fee, and student is suspended.
- 5th Offense - Parent Contact, Phone confiscated, parent must retrieve phone with a \$15 fee, and student is recommended to attend ALC.
- 6th Offense & Beyond – Recommend ALC Placement

Misuse Of Technology Resources And The Internet

The use of mobile phones or any device during tests is strictly prohibited. Any person with a phone/device out during a test will have their phone confiscated immediately for parent pickup and will receive a zero. The use of mobile phones or any device in restrooms and/or locker rooms is strictly prohibited. Any person using their phones in these areas will have their device confiscated immediately for parent pickup and will be disciplined according to the Student Code of Conduct and will be reported to law enforcement in accordance with the Texas Penal Code.

Misuse of Technology Resources and The Internet

Misuse Of Technology Resources And The Internet

The use of mobile phones or any device during tests is strictly prohibited. Any person with a phone/device out during a test will have their phone confiscated immediately for parent pickup and will receive a zero. The use of mobile phones or any device in restrooms and/or locker rooms is strictly prohibited. If an individual uses a phone to video individuals in a private setting (bathroom/locker room) or compromising situation, then it will be coded a "State Jail Felony" and is a mandatory DAEP placement. Any person using their phones in these areas will have their device confiscated immediately for parent pickup and will be disciplined according to the Student Code of Conduct and will be reported to law enforcement in accordance with the Texas Penal Code.

Possession of Telecommunications or Other Electronic Devices

Possession Of Telecommunications Or Other Electronic Devices

Students are allowed to bring their own telecommunication devices to school. This includes, but is not limited to: cell phones, smart phones, iPads, earbuds, tablets and laptop computers. All devices must remain in student backpacks for the duration of the day. Students will be allowed to take out and use their devices at lunch only unless otherwise directed by administration. Teachers also have discretion to allow device use in class for instruction purposes only. Students must follow teacher and district rules in regards to using their device. Using a phone in school is a privilege that can be revoked at any time.

Telecommunication devices that disrupt the education process, are used inappropriately or when not directed by a teacher or staff member, or used in violation of the Student Code of Conduct will be confiscated. School personnel will write an office referral and it will be turned into the principal's office. If this is the students first offense, they will be allowed to retrieve their device at the end of the school day. If the student is leaving early they must return at the end of the school day to retrieve their device, no exceptions will be made. Repeated offenses will require parent/guardian, and/or a third party that retains legal right of ownership to obtain a release of the electronic device for a monetary fee of \$15. For more details please see the Student Telecommunication Device Policy.

Inappropriate Use of Cell Phone Practice

Inappropriate use of Cell Phone Practice:

- 1st Offense – Parent Contact, Phone confiscated and returned at end of day.
- 2nd Offense – Parent Contact, Phone confiscated, and parent must retrieve phone with a \$15 fee.
- 3rd Offense – Parent Contact, Phone confiscated, parent must retrieve phone with a \$15 fee, and student is assigned ISS.
- 4th Offense - Parent Contact, Phone confiscated, parent must retrieve phone with a \$15 fee, and student is suspended.
- 5th Offense - Parent Contact, Phone confiscated, parent must retrieve phone with a \$15 fee, and student is recommended to attend ALC.
- 6th Offense & Beyond – Recommend ALC Placement

Misuse Of Technology Resources And The Internet

The use of mobile phones or any device during tests is strictly prohibited. Any person with a phone/device out during a test will have their phone confiscated immediately for parent pickup and will receive a zero. The use of mobile phones or any device in restrooms and/or locker rooms is strictly prohibited. Any person using their phones in these areas will have their device confiscated immediately for parent pickup and will be disciplined according to the Student Code of Conduct and will be reported to law enforcement in accordance with the Texas Penal Code.

Safety Transgressions

Safety Transgressions

Students shall not:

- Possess published or electronic material that is designed to promote or encourage illegal behavior or that could threaten school safety.
- Engage in verbal (oral or written) exchanges that threaten the safety of another student, a school employee, or school property.
- Make false accusations or perpetrate hoaxes regarding school safety.
- Engage in any conduct that school officials might reasonably believe will substantially disrupt the school program or incite violence.
- Throw objects that can cause bodily injury or property damage.
- Discharge a fire extinguisher or activating a fire alarm without valid cause.
- Be in a location, such as bus, gymnasium, teacher workroom, unassigned classroom, choir room, restroom, custodial closets, hallway, auditorium, athletics' field/court, playground, locker room, band room, cafeteria, offices, etc. without approval.

Techniques

Techniques

The following discipline management techniques may be used—alone or in combination—for behavior prohibited by the Student Code of Conduct or by campus or classroom rules:

- Verbal correction, oral or written.
- Cooling-off time or a brief “time-out” period, in accordance with law.
- Seating changes within the classroom or vehicles owned or operated by the district.
- Temporary confiscation of items that disrupt the educational process. Parents may obtain the release of the cellular phone or other electronic devices for a fine of \$15.00. After the 30-day period has expired, the District shall dispose of the communication device.
- Rewards.
- Behavioral contracts.
- Restorative Discipline practices.
- Counseling by teachers, school counselors, or administrative personnel.
- Parent-teacher conferences.
- Grade reductions (including receiving a zero) for cheating, plagiarism, use of an unapproved electronic device, and as otherwise permitted by policy.

Possession of a Telecommunications or Other Electronic Devices

Possession Of Telecommunications Or Other Electronic Devices

These items that disrupt the education process by being on will be temporarily confiscated. School personnel will collect the electronic device and turn it in to the principal's office. Parents, guardians, and/or a third party that retains legal right of ownership may obtain a release of the electronic device for a monetary fine. After a 30-day period has expired, the school shall dispose of the electronic device. A student who refuses to turn over his/her electronic device when asked by a school employee will have a disciplinary action in accordance with the Student Code of Conduct, ranging from a ~~minor~~ major offense to an expellable offense. The use of a mobile telephone or any device capable of capturing images of any violation of the student code of conduct is strictly prohibited while at school or at a school-related or school-sponsored events.

Activity/Club Sponsors

Art Club: Paloma Garrido

Athletics/PE/Concessions: Brandon Allen

Band/Orchestra: Andrew Mitchell

Boys to Gent's: Hansen Harper/Ryan Gusman

Book Club: Dawn McGowen

Campus Webmasters: Dawn McGowen/Denise Evans

Campus Facebook: Chamekia Fields

Campus Twitter: All Administrators

Cheer: Devon Hertzler

Chess/Checkers: Alfred Guzman

Choir: Parker Yarnall

Community Outreach: Greg Tielke/Aimee Uribe/Holly Rose

Girls of Excellence: TBD

Girls Who Code: TBD

FFA (Future Farmers of America): Deborah Korenek

NJHS (National Junior High School Association): TBD

Science Olympiad: Emely Placidon

Social Studies Quiz Bowl: Lee Zuskind

Student Council: TBD

TSA (Technology Student Association): Allen Gerbermann

UIL Academic Coordinator: Shawna Hardy



Clubs Organizations

My First Day

Gym or Cafeteria

Report to 1st Period

Pick up schedule & SMART Tag
1st Period

Student's w/ attend class learn
classroom/campus expectations

Students' mode of transportation
will be verified multiple times

Dismissal





Mustang Support Squad

**RISE
STAMPEDE**

Aimee Uribe (Principal Secretary)
aimee.uribe@lcisd.org

Holly Rose (Amazing LJH Teacher)
holly.hutson@lcisd.org

Marni Marrero (Amazing Mustang Parent)

Thank You

